

FRONTAL²⁴

Entrance Doors

ST40

FRONTAL24.COM





Table of Contents

Door type ST40	5
Standard structure RAL colours	7
Features	9
Frame types	11
Threshold types and specifications	12
Specifications	19
Locks and handles	20
Glazing	22
Accessories	22



Door type ST40
Outside colour RAL 9005
Handle Black (BL)

Door type ST40

Made of 1 mm galvanised steel skin filled with PU that forms firm and durable construction.

- Double galvanised steel skin filled with PU foam door leaf
- Double sealing
- Tested at 200 000 open-close cycles



1.3 W/m²K*
Thermal transmittance
U value



2
Air permeability



4A
Water tightness



3
Resistance to wind load,
test pressure



C
Resistance to wind load,
frame deflection



All doors are factory framed.
Prices are for full door-sets.
All dimensions are specified for overall frame sizes.
Depicted images are for illustration only. Actual product may vary
due to constant enhancement.
Frontal reserves right to change specifications at any time and
without prior warning.

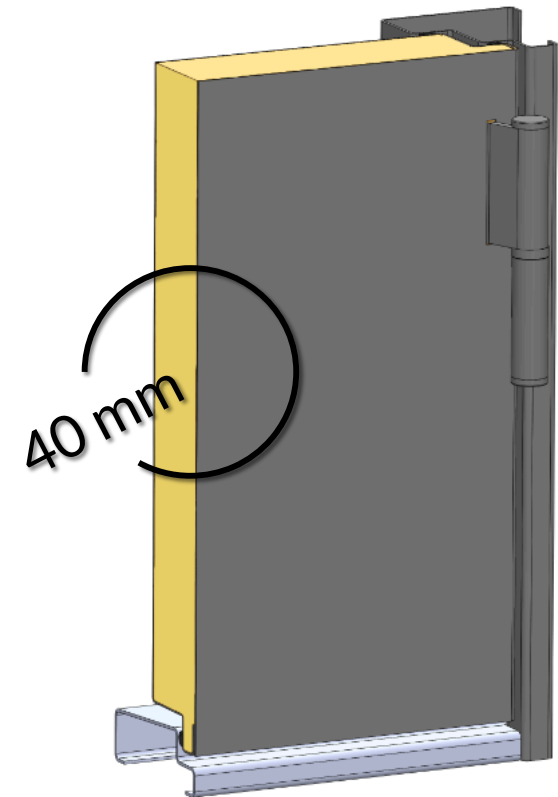

Doors are made to measure:

STD:

890 x 1990

890 x 2090

990 x 1990

990 x 2090

On request:

Width 700 ÷ 1150

Height 1700 ÷ 2250



Door type ST40 HOME
Outside colour Golden Oak
Handle HLA
Applique Brushed aluminium appliqué

Standard structure RAL colours





Door type ST40
Outside colour RAL 9006
Handle Black (BL)

Features

Entrance doors are made of 1 mm galvanised steel skin filled with PU that forms firm and durable construction.

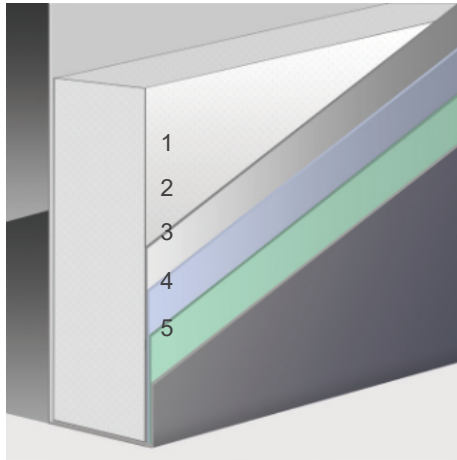

Door Leaf Structure

- Polyurethane foam
- Cold rolled steel
- Hot dip galvanisation
- Chemical treatment
- Powder paint

U-value up to
1,3 W/M²K

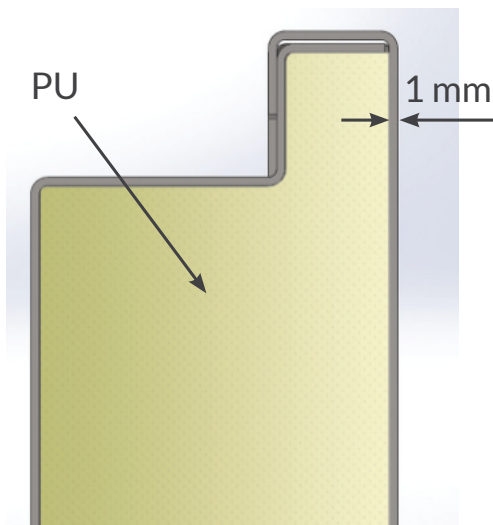

Corrosion protected 1 mm skins linked together, with 40mm PU insulation and forms solid "sandwich panel".

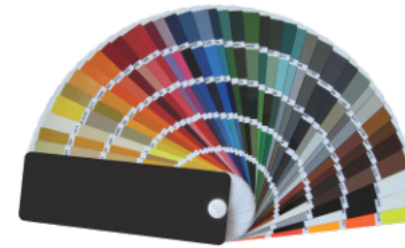

6 STD RAL STRUCTURE colours.
Painting available upon request.
Only structure painting.



3 pcs, adjustable hinges with Bearing ensure long - life, smooth and quiet operation.

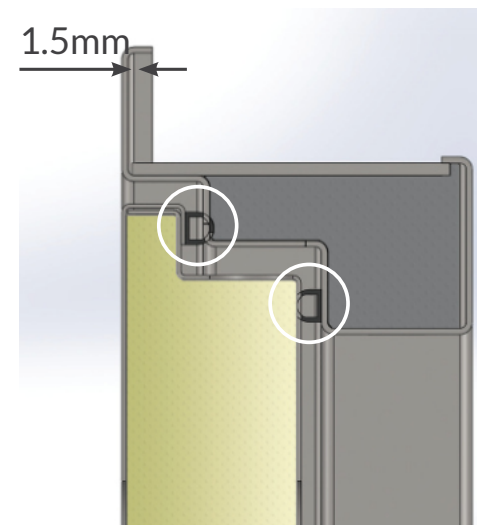

Double sealing around all the perimeter provides excellent thermal insulation and water resistance.

Door frame made of 1.5 mm thickness galvanised steel.



Door type ST40
Outside colour RAL 5010
Handle Black (BL)

Frame types

MITRED FRAME WITH MOULDINGS, OPEN TO OUTSIDE (MO)

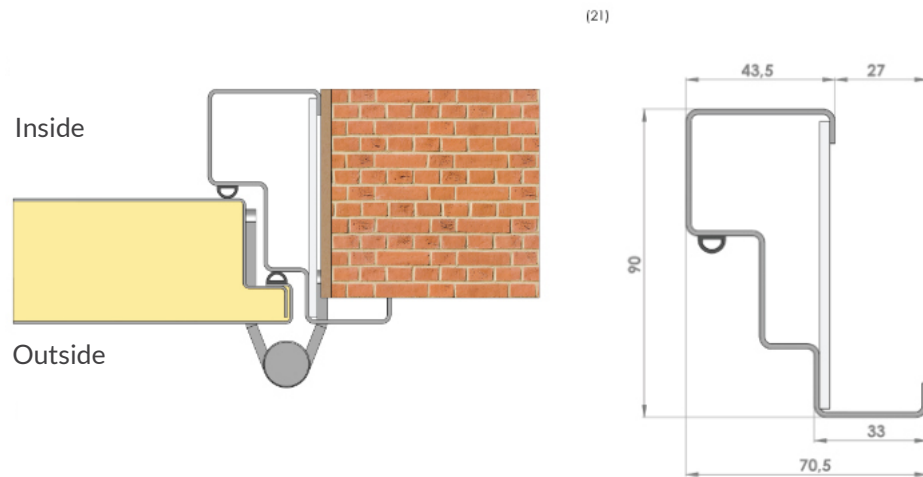

MITRED FRAME WITH MOULDINGS, OPEN TO INSIDE (MI)

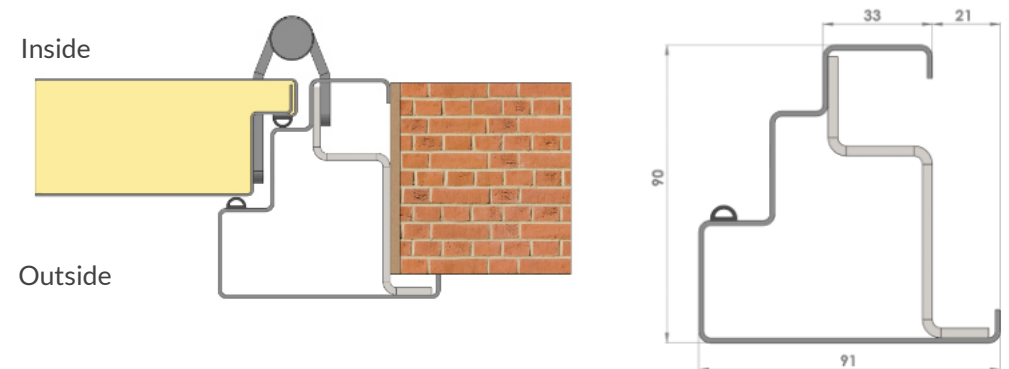

MITRED FRAME, OPEN TO OUTSIDE (LO)

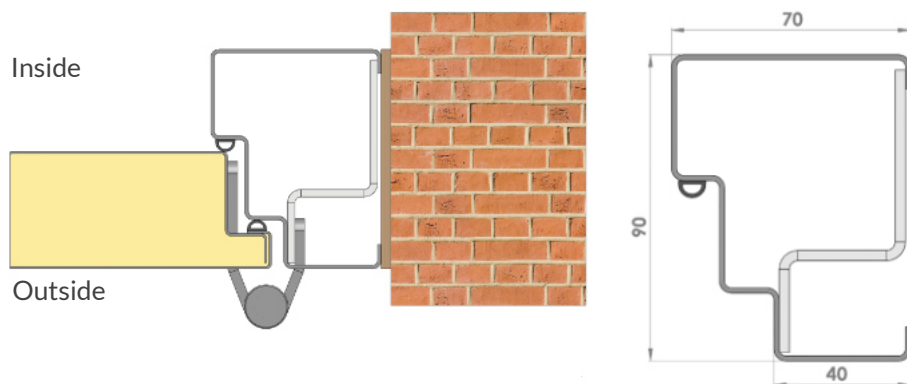

MITRED FRAME, OPEN TO INSIDE (LI)

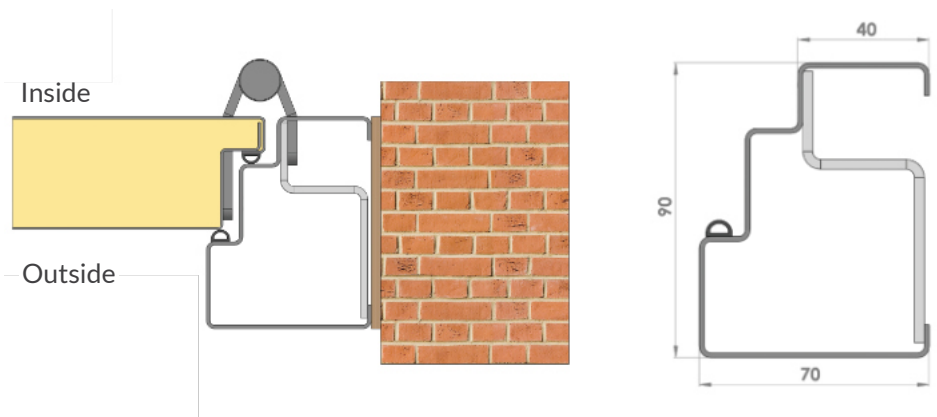

Threshold types and specifications

DOUBLE SEALING THRESHOLD, OPEN TO OUTSIDE (OD)

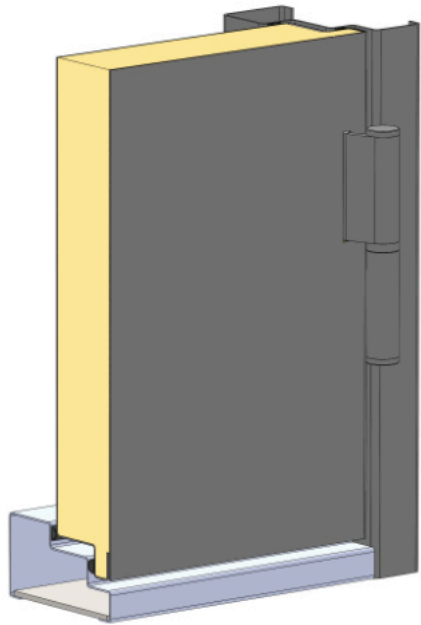

MO-OD

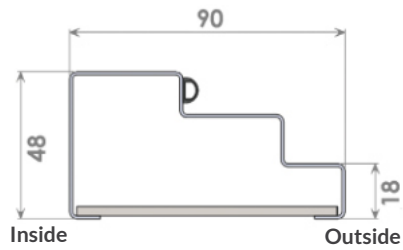
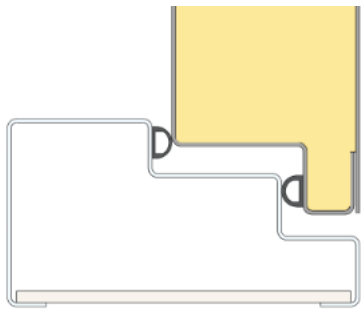

OFS & DAYLIGHT OPENING

MO frame

Outside



Inside

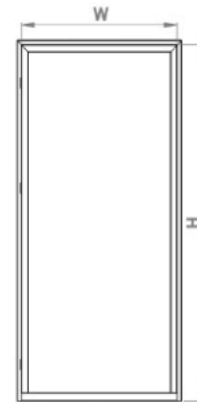

LO frame

Outside

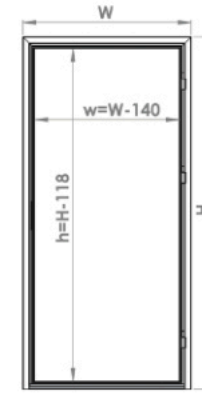

Inside

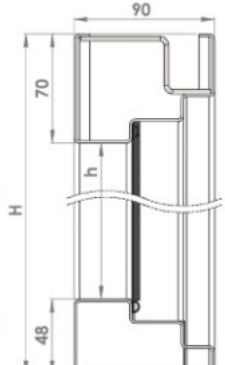
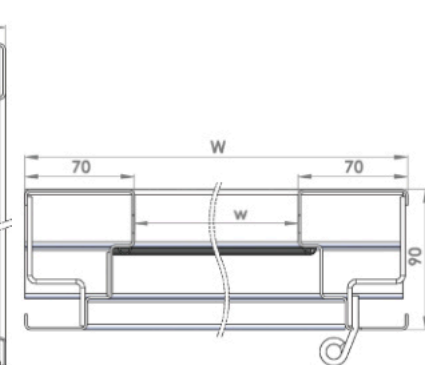
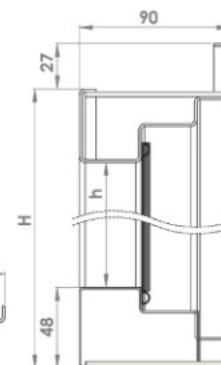
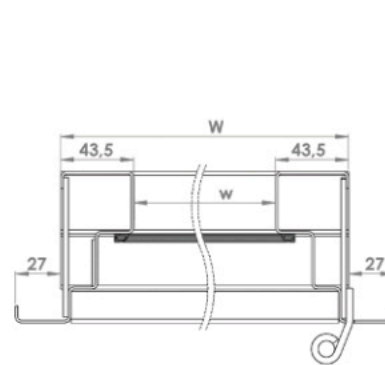
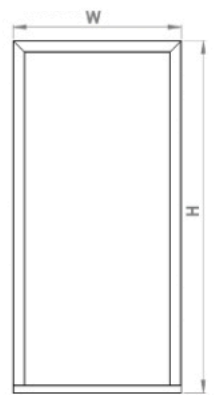

SINGLE SEALING THRESHOLD, OPEN TO OUTSIDE (OS)

OFS & DAYLIGHT OPENING

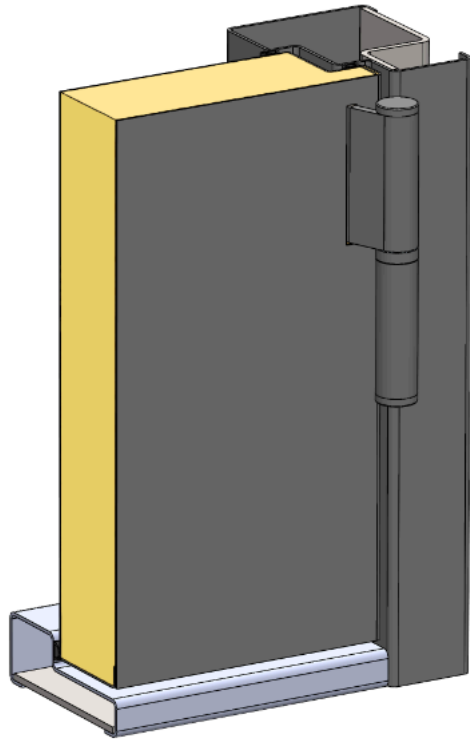

LO-OS

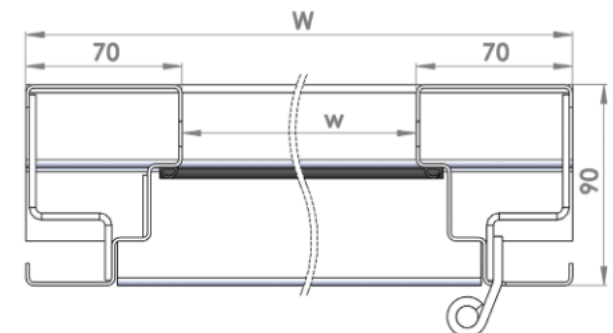
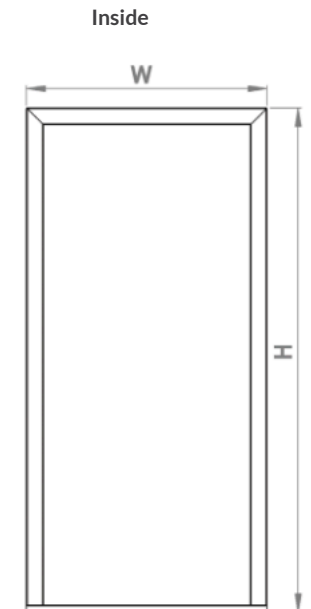
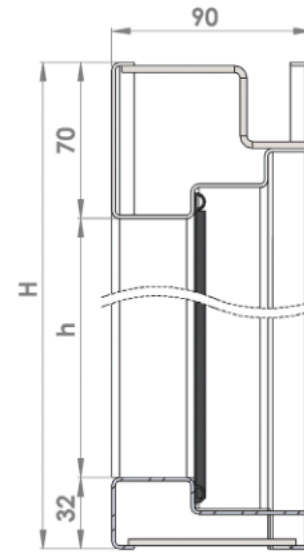
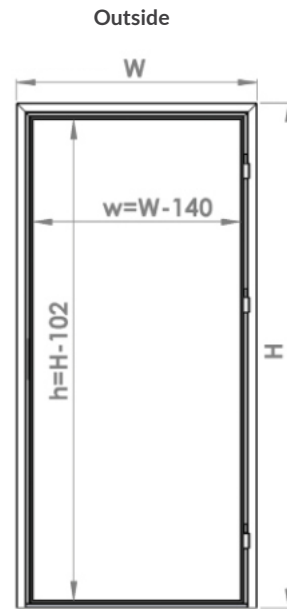
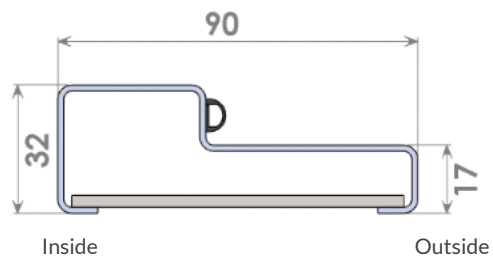
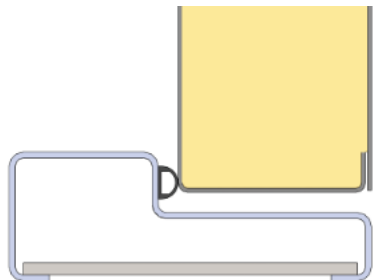

SINGLE SEALING THRESHOLD, OPEN TO OUTSIDE (OS2)

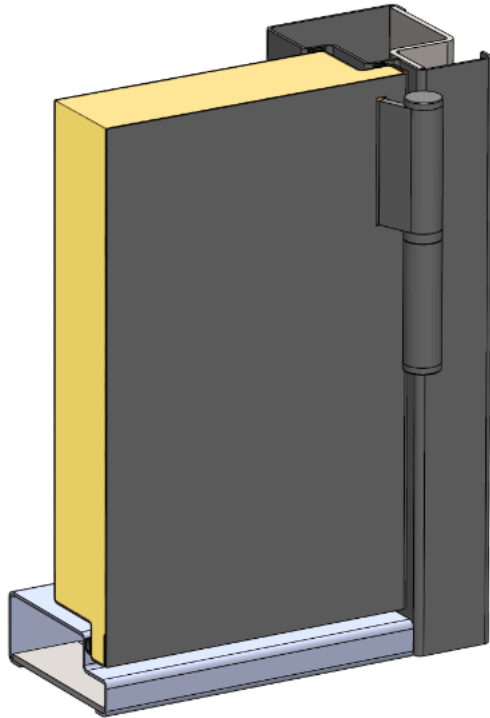

LO-OS2

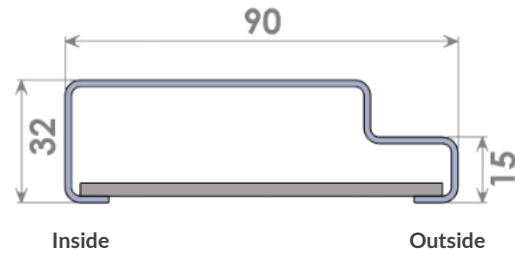
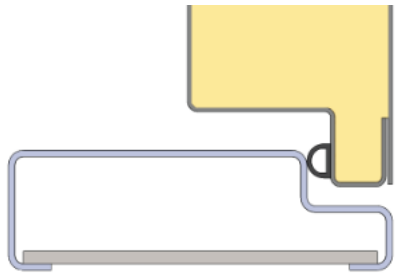

OFS & DAYLIGHT OPENING

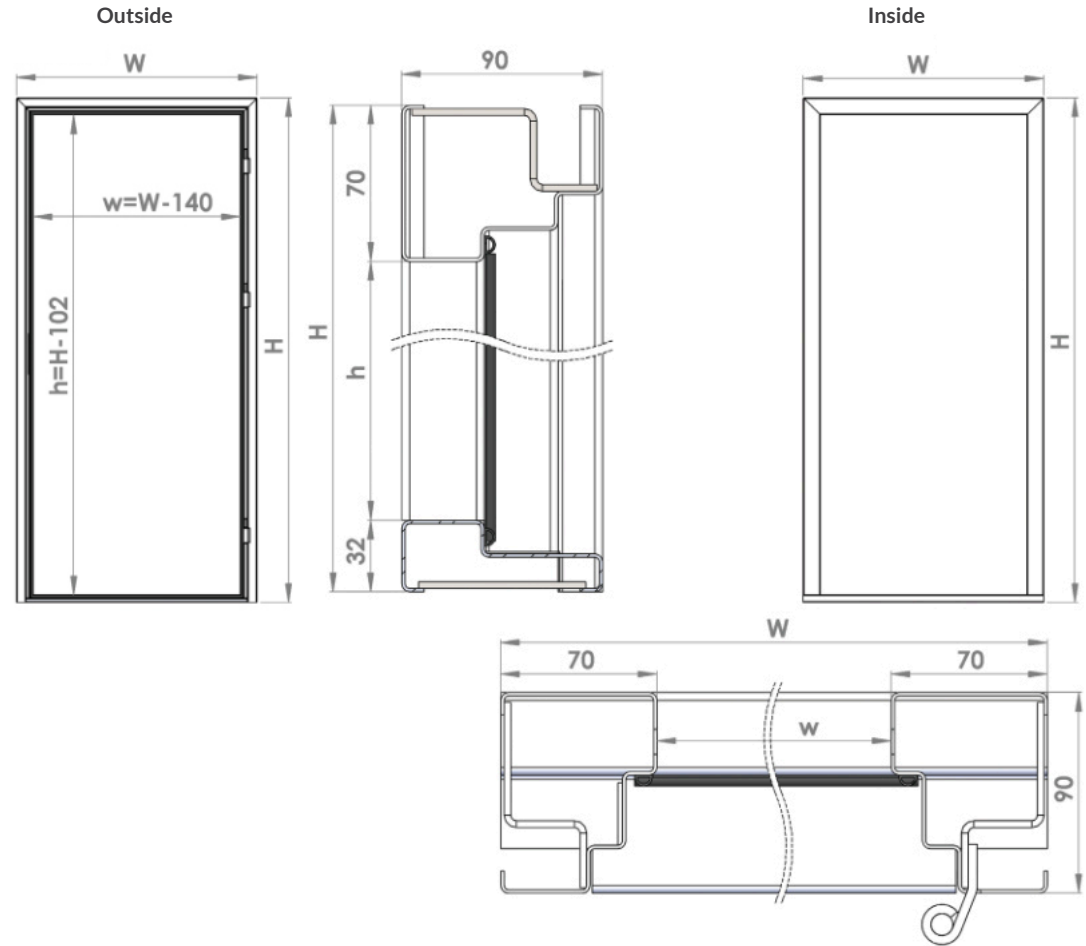

MITRED FRAME WITH MOULDINGS, OPEN TO OUTSIDE (OM)

OFS & DAYLIGHT OPENING

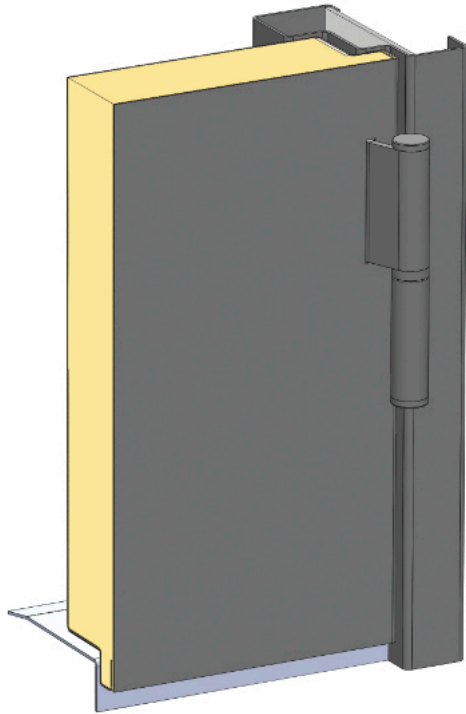

MO-OM

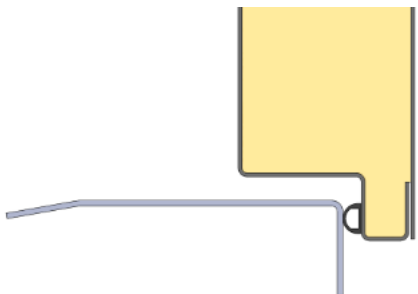

Inside



Outside

Outside



$h=H-45$
 $w=W-87$

Inside

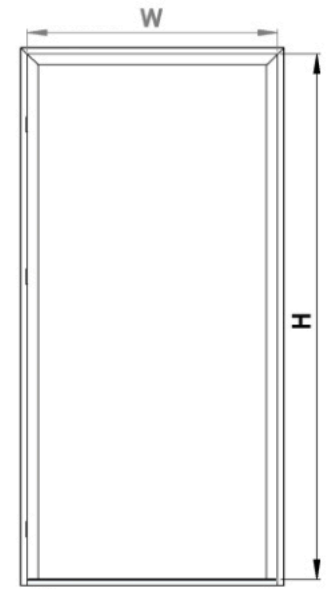

W

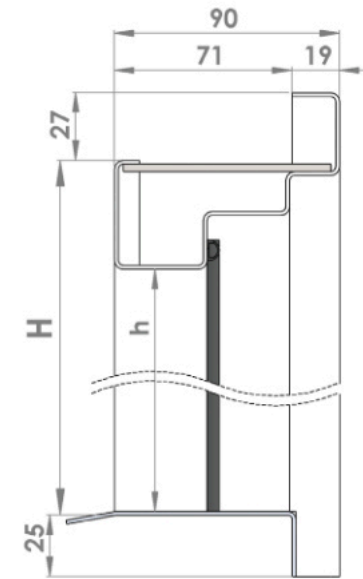

90
71 19
27
H
h

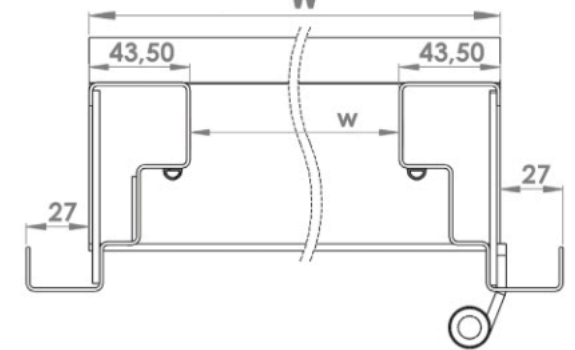

43,50 43,50
27
W
w

WITHOUT THRESHOLD, OPEN TO OUTSIDE (OW)

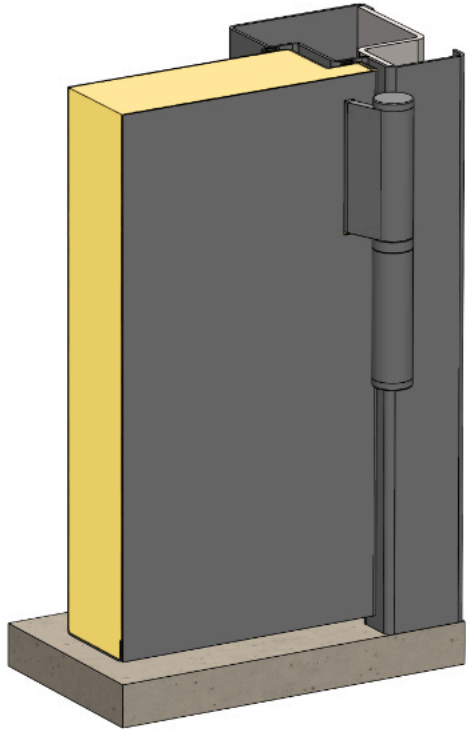

OFS & DAYLIGHT OPENING

MO frame

Outside

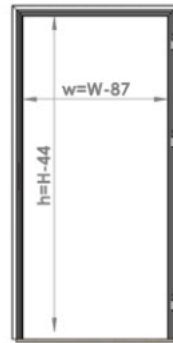

Inside

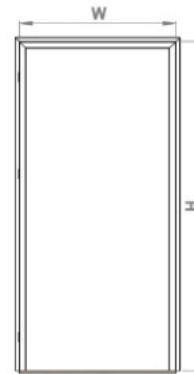

LO frame

Outside

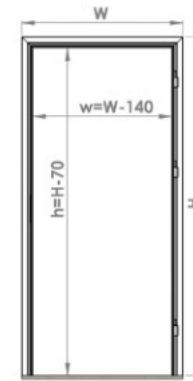

Inside

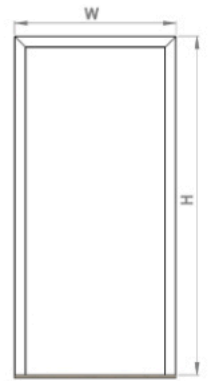

LO-OW

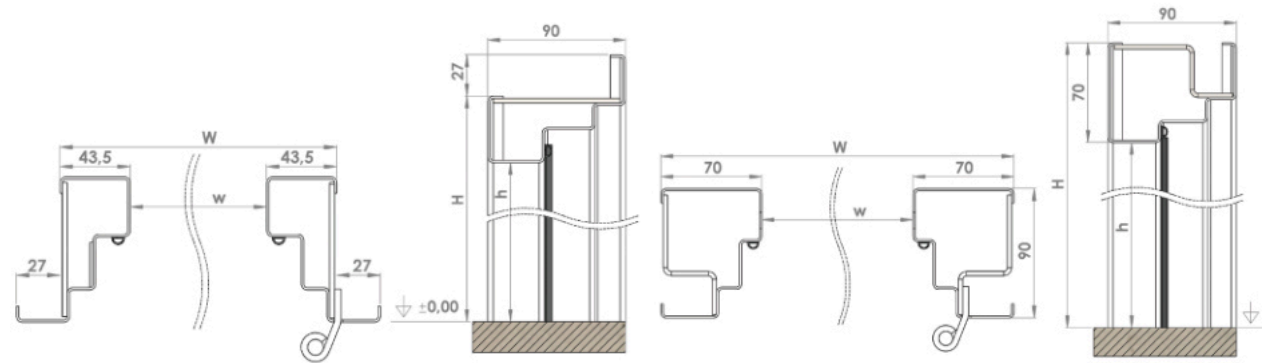
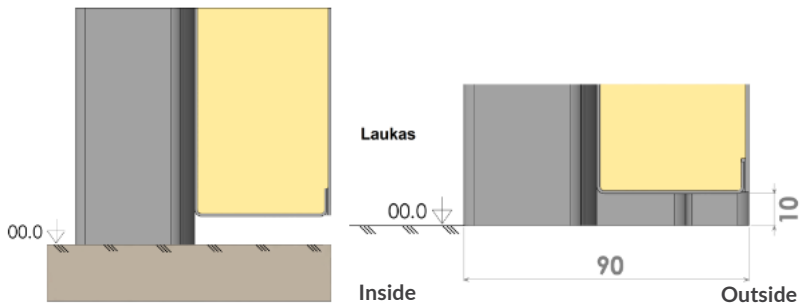

SINGLE SEALING ANGLED THRESHOLD, OPEN TO INSIDE (IS)

OFS & DAYLIGHT OPENING

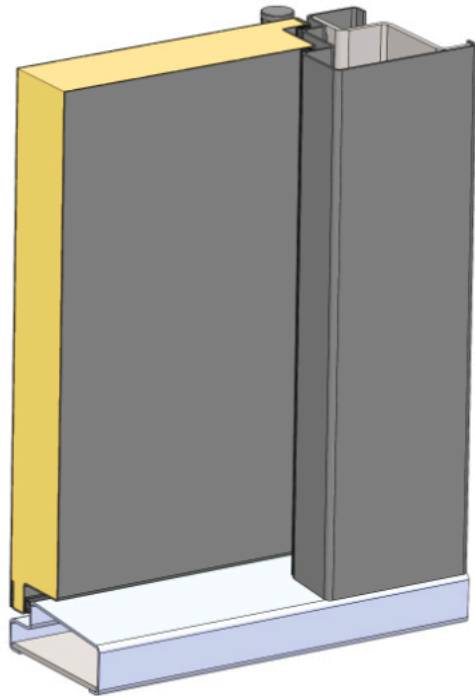

LI-IS

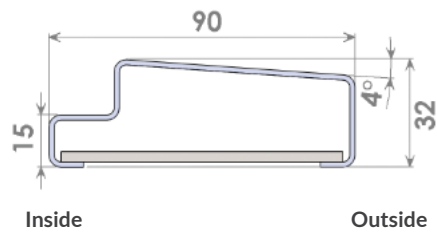
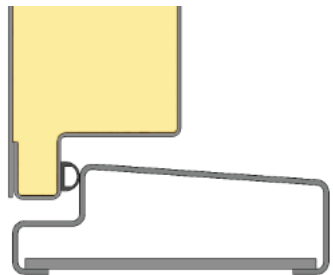

MI frame

LI frame

Outside

Inside

Outside

Inside

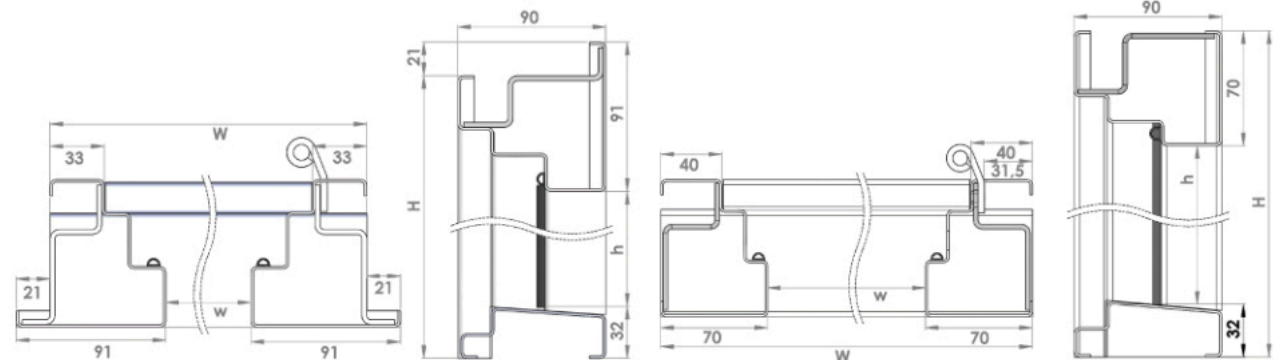
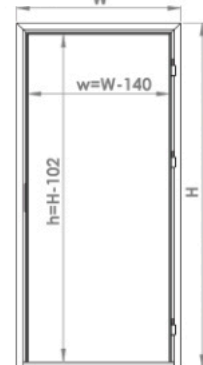
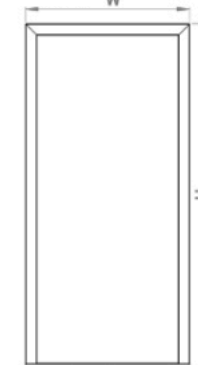
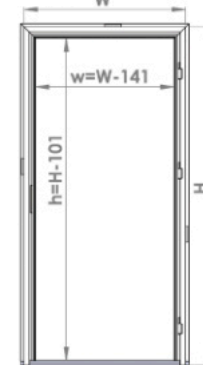

WITHOUT THRESHOLD, OPEN TO INSIDE (IW)

OFS & DAYLIGHT OPENING

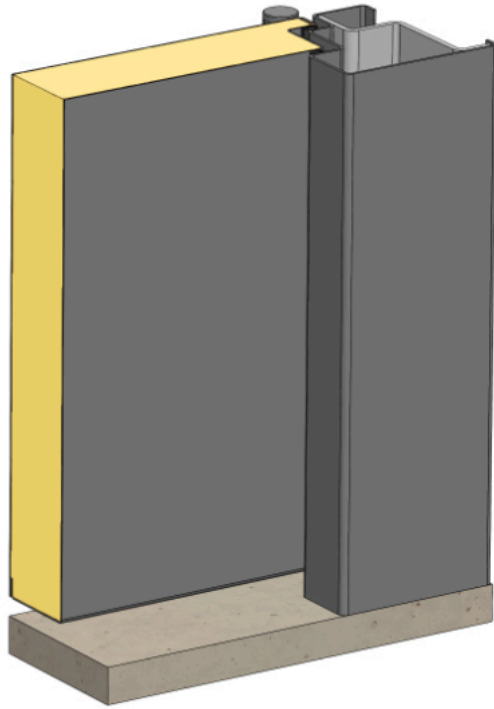

MI frame

LI frame

Outside

Inside

Outside

Inside

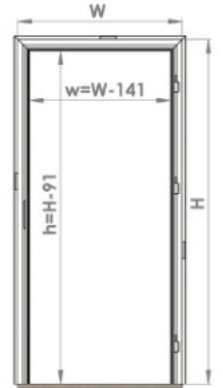
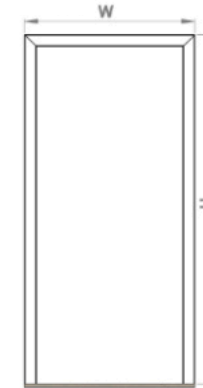
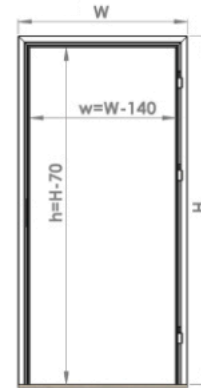

LI-IW

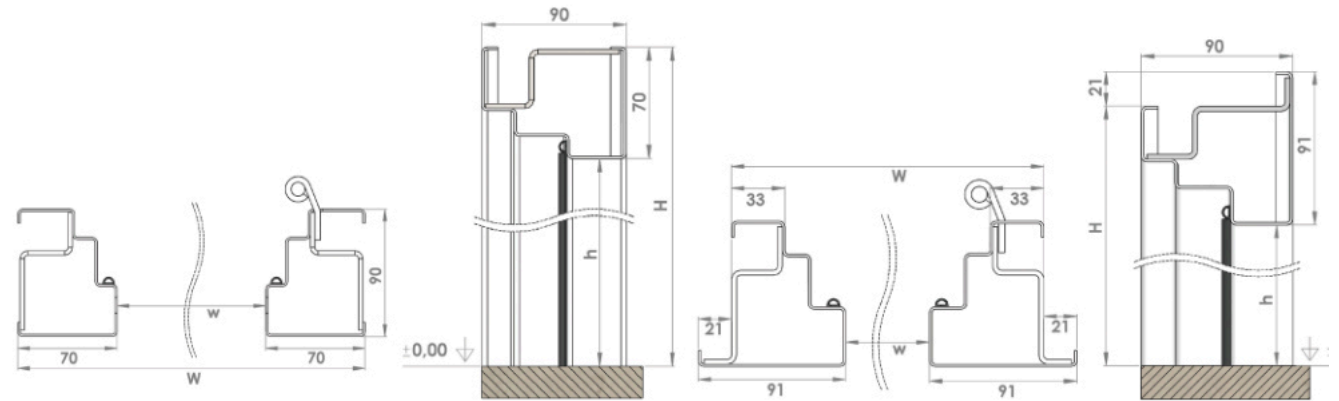
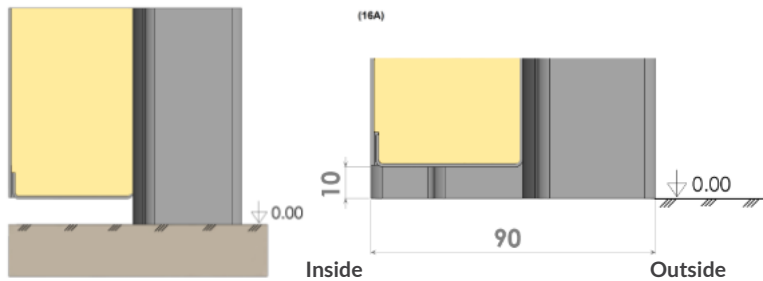

Specifications

MO OPEN LEAF 90°

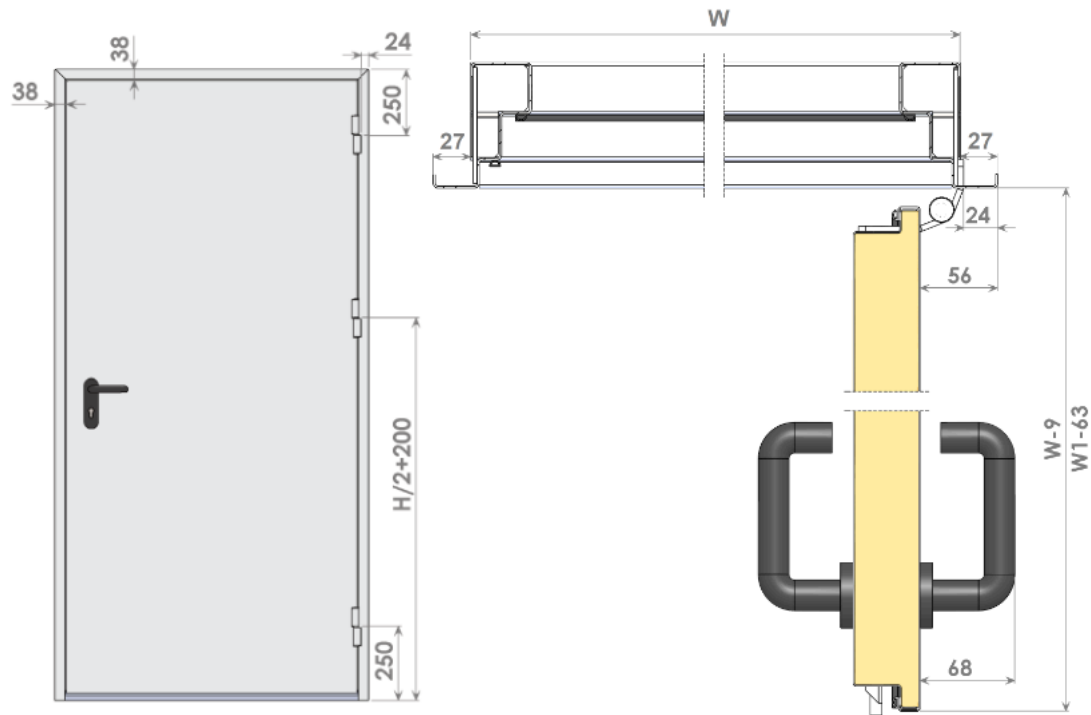

LO OPEN LEAF 90°

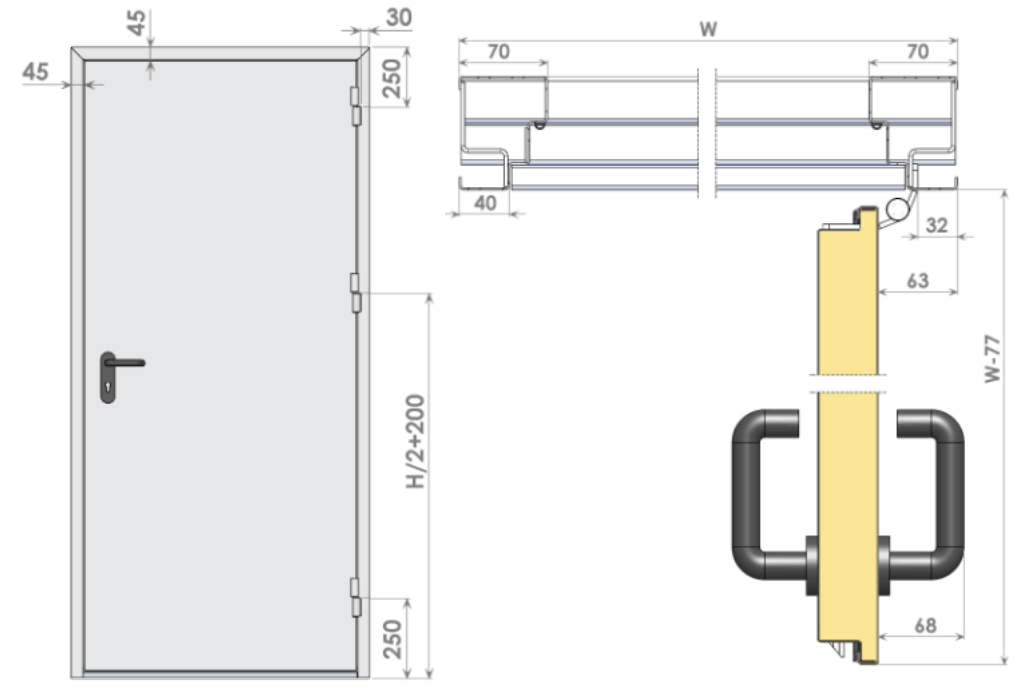

Locks and handles



Lock
STD



BL
Black lever handle
STD



GR
Grey lever handle
STD



ST
Stainless steel
lever handle



SSK
Stainless steel
knob handle



CWD
Lock cylinder
STD



HL
White
lever handle



HK
White
knob handle



HLA
Aluminium
lever handle



CWF
Lock cylinder



LC 100
Lock



565
Lock



AS
Lever handle



CWE
Lock cylinder



C3P
Multi-point lock

D&N+EM



APL
Lock



SSK
Stainless steel
knob handle



APLH
Anti-panic
handle



CWAP
Lock cylinder



Door type ST40
Outside colour RAL 1012
Handle Black (BL)
Glazing S100

Glazing



S200
Square glazing
200x200 mm



S350
Square glazing
350x350 mm



S100
Rectangular glazing
100x700 mm



S500
Rectangular glazing
500x700 mm

Accessories

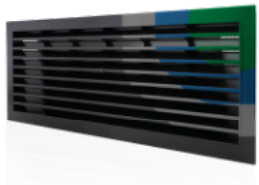

Ventilation grille



Spy hole



Door closer
GEZE



PL201
Padlock staple



KP1
Keypad

matching

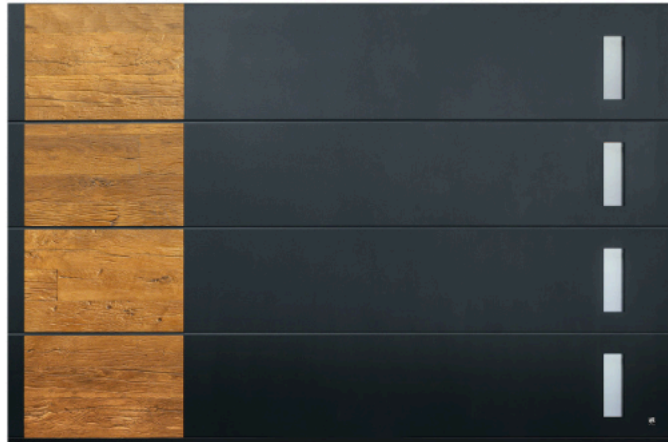

GARAGE DOORS



FRONT DOORS



GATES & FENCES

It's never been easier to get a unique matching design. Front and garage door, aluminium gate and fence from one manufacturer. Same design, same colour, same accents - hassle-free.

The images in this catalogue showcase different configurations and may include additional non-standard accessories. • We reserve the right to implement improvements and update designs without prior notice. • The depicted colours in this brochure are illustrative and may vary from actual product colours. • All rights reserved. • Unauthorised reproduction or distribution of this catalogue in whole or in part is available only with consent from us.

